

M Series Horizontal Multi-Cartridge

CARTRIDGE FILTER HOUSINGS

Designed for Use with High Flow Type Cartridges

INTRODUCTION

The M series (formerly Nowata) horizontal, multi-cartridge housing utilizes a full length riser post to properly align cartridges during installation and ensure a positive seal. This prevents improper reseating of cartridges prior to being placed into service and also keeps possible system back pressure from dislodging the elements from their respective seals. The design also includes an internal element support plate to aid in dirty element removal without damage to element supports from dead weight deflection.

These housings are designed to be used with Jonell Systems JHFO High Flow type elements.

Filter cartridge access is conveniently located close to the operators waist making filter change-out quick and easy. Standard material of construction is carbon steel or stainless steel. In stainless steel construction, all wetted parts are stainless. The following non-wetted parts are made of carbon steel; Zinc plated bolts and nuts, davit arm assembly, leg assembly, and bolting lug assemblies.

FEATURES

- Housings contain twice as much surface area for the same diameter vessel as competitive products
- Unique guide tubes for easy, accurate installation of cartridges
- Dual O-Rings on elements seal themselves as the vessel cover is tightened, insuring no liquid bypass. Springs or cups are not used
- Gauge ports and drain ports are pre-tapped making gauges and valves easy to install
- Multiple options for housing o-rings
- Optional air eliminator that releases air from the vessel which eliminates manual venting. Automatic venting insures full use of the available filter surface area
- Vessels meet ASME Code Section VIII, Division I which insures premium material and construction for safety, quality and longer vessel life
- Wide range of pressures available
- Other closure types available



For more information:

WEB: FLTR.com.au **PHONE:** (+61) 1300 62 4020 **EMAIL:** info@FLTR.com.au **SKYPE:** Purple.Engineering

DIMENSIONAL INFORMATION

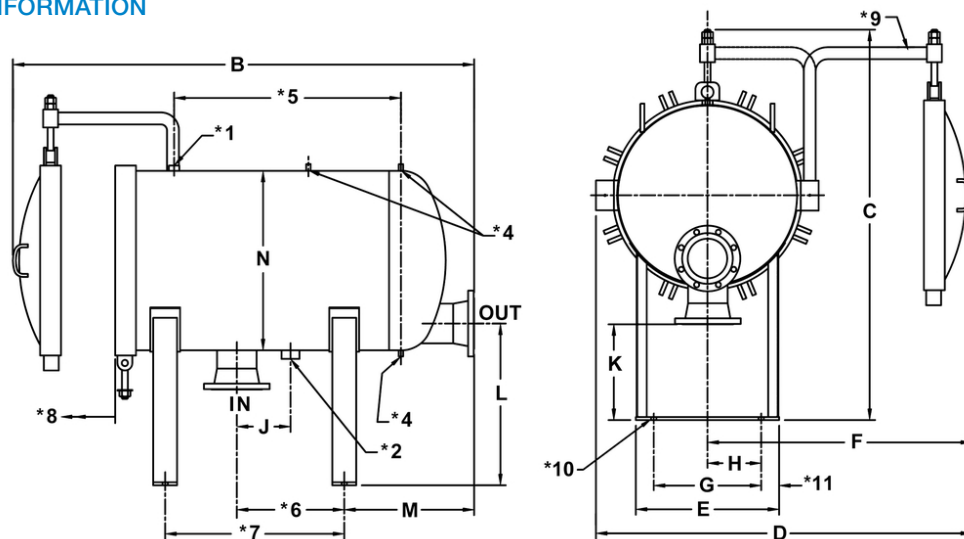

No. of Cartridges	Inlet / Outlet Size	B	C	D	E	F	G	H	J	K	L	M	N
4	4	64 ⁷ / ₈	44 ⁷ / ₈	38 ³ / ₈	14½	26¾	8½	4¼	9	13	20½	16	18
5	4	65¾	49½	40¾	16	28½	10	5	9	13	21½	16½	20
7	6	68¾	56 ⁷ / ₈	51 ⁷ / ₈	19½	35 ³ / ₈	13½	6¾	9	16	26	17½	24
11	6	77¼	65¼	63	24	44 ³ / ₈	18	9	9	16	27	21¾	30
18	8	87½	75 ⁷ / ₈	79¾	29	58¾	23	11½	9	20	32	20½	36
21	8	96 ⁷ / ₈	84	92 ⁷ / ₈	34	67 ⁷ / ₈	28	14	9	20	33	22	42
29	10	102 ⁵ / ₈	94 ⁷ / ₈	97 ³ / ₈	39	69¾	33	16½	11	23	38	23½	48

Dimensions in inches except where noted. Due to our continuing program of product improvement, specifications are for reference only and subject to change without notice. Dimensions are approximate values and not intended for piping specifications.

NOTES: *1 = 1 inch FNPT *4 = Drain ¼ inch *6 = 18 inches *8 = 40 inches clearance required *9 = Davit arm assembly
 *2 = Drain 2 inches *5 = 38 inches *7 = 30 inches for element removal *10 = 7/8 inch x 1 1/2 inch slotted holes (typically 4 places)

TYPICAL MODEL NUMBER

[illegible]

For more information:

WEB: FLTR.com.au **PHONE:** (+61) 1300 62 4020 **EMAIL:** info@FLTR.com.au **SKYPE:** Purple.Engineering

