

FRONT VIEW

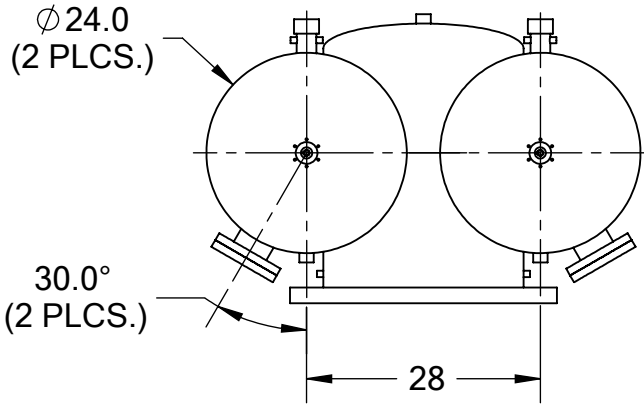

BACK VIEW

REVISIONS				
REV.	ZONE	DESCRIPTION	DATE	INITIAL

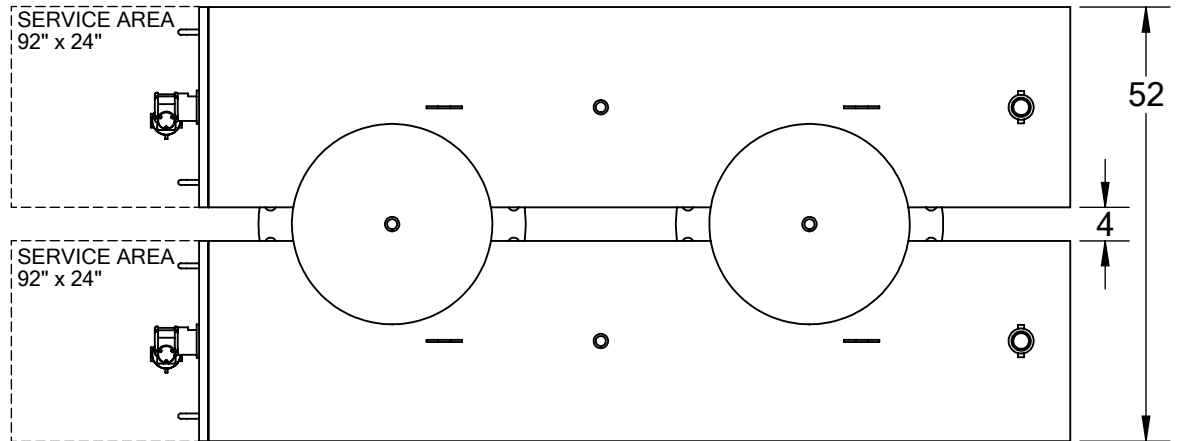

TOP VIEW

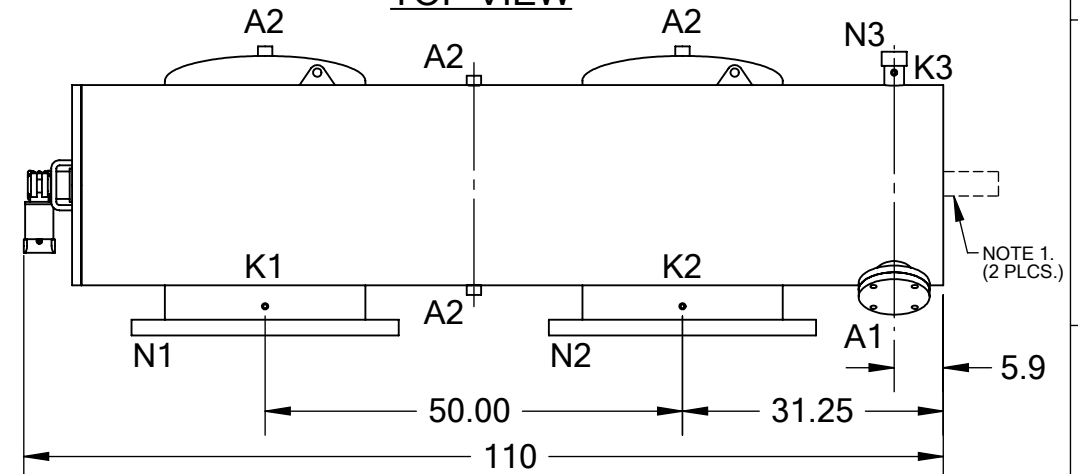

SIDE VIEW

- NOTES:
- PLEASE ALLOW ~20" ADDITIONAL TO INSTALL AND REMOVE THE PISTON ASSEMBLY TO THE BACKSIDE OF THE FILTER.
 - SOME DIMENSIONS MAY VARY SLIGHTLY UPON CONSTRUCTION.

TECHNICAL DATA

FLOW RATE	MAX. 12,000 GPM (2,725 m ³ /hr)
SCREEN SIZE	___ MICRON
SCREEN AREA	32.0 SQ. FT. (2 x 16.0 SQ. FT.)
DESIGN TEMPERATURE	160 °F
DESIGN PRESSURE	150 PSI
EMPTY WEIGHT	~3,000 LBS.
FULL WEIGHT	~6,500 LBS.

NOZZLE	CONNECTION	TYPE	SIZE	RATING
A1	SERVICE PORT	FLANGED	3.5" ASA(2)	CL. #150 F.F. w/ Blind
A2	PRESSURE RELEASE	THREADED	1" NPT(6)	
K1	HIGH PRESSURE CONN.	THREADED	1/4" NPT(2)	CLASS #150 F.F.S.O.
K2	LOW PRESSURE CONN.	THREADED	1/4" NPT(2)	
K3	HYDRAULIC CONN.	THREADED	1/4" NPT(4)	CLASS #150 F.F.S.O.
N1	INLET	FLANGED	24" ASA	
N2	OUTLET	FLANGED	24" ASA	CLASS #150 F.F.S.O.
N3	FLUSH OUTLET	THREADED	2" NPT(2)	

TOLERANCES
(UNLESS OTHERWISE SPECIFIED)

FRAC. ±1/16	ANGLE ±1°
.X ±.1	
.XX ±.05	
.XXX ±.010	



MATERIAL: SST	TITLE: LPF24-TLP FILTER, CUT DRAWING
DRAWN BY: S. PERKINSON	
DATE: 06/22/2016	DRAWING NUMBER LPF-24TLP-CUT-1
SCALE: 1:23	
SHEET: 1 OF 1	REV N/A