

REVISIONS				
REV.	ZONE	DESCRIPTION	DATE	INITIAL
1	3E	ADDED SERVICE AREA.	06/28/12	S.P.
2	1B,2B,2C,8D	CHANGED "WORKING" TO "DESIGN" & TEMPERATURE FROM 200°F TO 160°F IN TECHNICAL DATA TABLE, ADDED 4" TO INLET LENGTH, INCREASED OUTLET TO FLUSH OUTLET DIMENSION.	05/17/13	S.P.

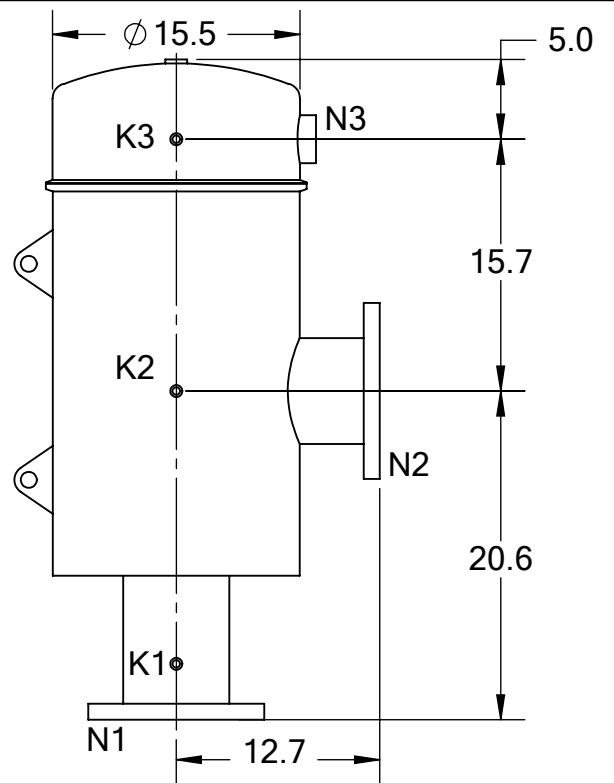

TECHNICAL DATA

FLOW RATE	MAX. 1,000 GPM (227 m ³ /hr)
SCREEN SIZE	___ MICRON
SCREEN AREA	5.0 SQ. FEET
DESIGN TEMPERATURE	160 °F
DESIGN PRESSURE	150 PSI
EMPTY WEIGHT	~175 LBS.
FULL WEIGHT	~425 LBS.

NOZZLE	CONNECTION	TYPE	SIZE	RATING
K1	HIGH PRESSURE CONN.	THREADED	1/4" NPT(2)	
K2	LOW PRESSURE CONN.	THREADED	1/4" NPT	
K3	HYDRAULIC CONN.	THREADED	1/4" NPT	
N1	INLET	FLANGED	6" ASA	CLASS #150 F.F.S.O.
N2	OUTLET	FLANGED	6" ASA	CLASS #150 F.F.S.O.
N3	FLUSH OUTLET	THREADED	2" NPT	

TOLERANCES (UNLESS OTHERWISE SPECIFIED)	
FRAC. ±1/16	ANGLE ±1°
.X ±.1	
.XX ±.05	
.XXX ±.010	
MATERIAL: SST	
DRAWN BY: S. PERKINSON	
DATE: 11/11/11	
SCALE: 1:12	SHEET: 1 OF 1



TITLE: MTF6-L FILTER, CUT DRAWING	
DRAWING NUMBER MTF-6L-CUT-01	REV 2