

REVISIONS				
REV.	ZONE	DESCRIPTION	DATE	INITIAL
1	1B,2B,2C,6D	CHANGED "WORKING" TO "DESIGN" & TEMPERATURE FROM 200°F TO 160°F IN TECHNICAL DATA TABLE, CHANGED INLET LENGTH FROM 5.0" TO 9.5", ADDED 2ND LIFTING LUG.	12/19/12	S.P.

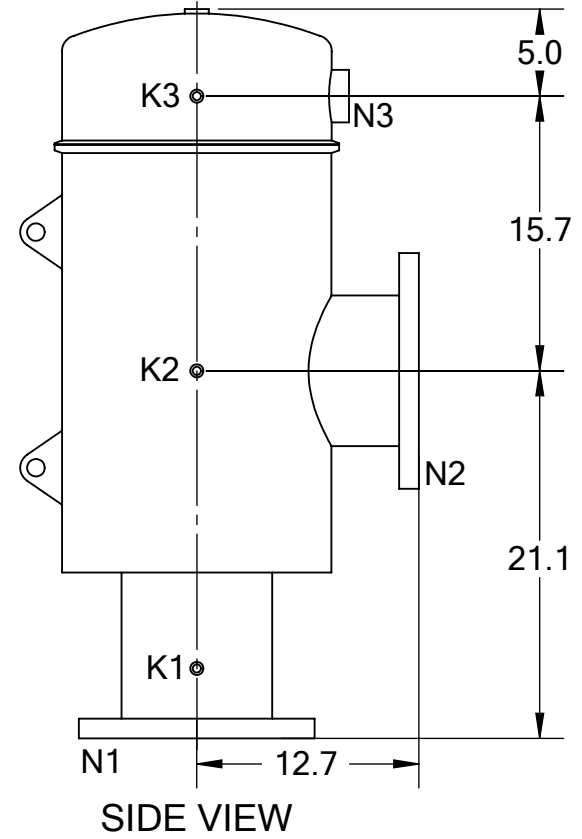

**TECHNICAL DATA**

FLOW RATE	MAX. 1,300 GPM (295 m <sup>3</sup> /hr)
SCREEN SIZE	____ MICRON
SCREEN AREA	5.0 SQ. FEET
DESIGN TEMPERATURE	160 °F
DESIGN PRESSURE	150 PSI
EMPTY WEIGHT	~175 LBS.
FULL WEIGHT	~425 LBS.

NOZZLE	CONNECTION	TYPE	SIZE	RATING
K1	HIGH PRESSURE CONN.	THREADED	1/4" NPT(2)	
K2	LOW PRESSURE CONN.	THREADED	1/4" NPT	
K3	HYDRAULIC CONN.	THREADED	1/4" NPT	
N1	INLET	FLANGED	8" ASA	CLASS #150 F.F.S.O.
N2	OUTLET	FLANGED	8" ASA	CLASS #150 F.F.S.O.
N3	FLUSH OUTLET	THREADED	2" NPT	

TOLERANCES (UNLESS OTHERWISE SPECIFIED)	
FRAC. ±1/16	ANGLE ±1°
.X ±.1	
.XX ±.05	
.XXX ±.010	
<b>MATERIAL:</b> SST	
<b>DRAWN BY:</b> S. PERKINSON	
<b>DATE:</b> 11/14/11	
<b>SCALE:</b> 1:11	<b>SHEET:</b> 1 OF 1



<b>TITLE:</b> MTF8 FILTER, CUT DRAWING	
<b>DRAWING NUMBER</b>	<b>REV</b>
MTF-8-CUT-01	1