



## UPVC High Pressure Bag Filter Housings

UPVC Bag Filter Housings feature excellent anti-corrosion by wide chemical compatibility. Compared with products made of stainless steel in the same dimensions, the UPVC filter housings advantage of lightness, low cost and rust free. All units are shipped with bag hold-down assembly to avoid bypass possibilities. Secure quick swing bolt closure makes element change out convenient and exhibits a better sealing performance, enabling the UPVC high pressure bag filter housings to withstand higher operating pressure in critical processes.

- Ⓞ **Free of rust contamination in process fluid because of excellent anti-corrosion ability.**
- Ⓞ **Compared with products made by stainless steel, the UPVC filter housings advantage of lightness and low cost.**
- Ⓞ **Quick swing bolt closure makes element change out convenient and provides a better sealing performance.**
- Ⓞ **All units are shipped with bag hold-down assembly to avoid bypass possibilities.**

### Applications

Pre RO, Desalination, Waste Water Treatment, Household Water Filtration

### Operation Data

Maximum Operating Temperature : 60°C (140°F)  
Maximum Operating Pressure : 7 bar(102 psi)

### Ordering Information

Type	Bag Size	Material of Construction	Number of Bag	Inlet/Outlet Size (inch/mm)	O-ring Option
<b>UFBG</b> High Pressure Bag Filter Housing	<b>01-</b> Size 1 <b>02-</b> Size 2	<b>U</b> - UPVC	<b>1</b> - 1 pce	<b>A20</b> - ANSI 2" Flange(63mm) <b>D50</b> - DIN 50 Flange(50mm)	<b>E</b> -EPDM <b>V</b> -Viton <b>S</b> -Silicone
<b>UFBG</b> High Pressure Bag Filter Housing	<b>02</b> Size 2	<b>U</b> UPVC	<b>1</b> 1 pce	<b>A20</b> ANSI 2" Flange	<b>S</b> Silicone O-ring

For more information:

WEB: FLTR.com.au PHONE: (+61) 1300 62 4020 EMAIL: info@FLTR.com.au SKYPE: Purple.Engineering

# UPVC High Pressure Bag Filter Housings

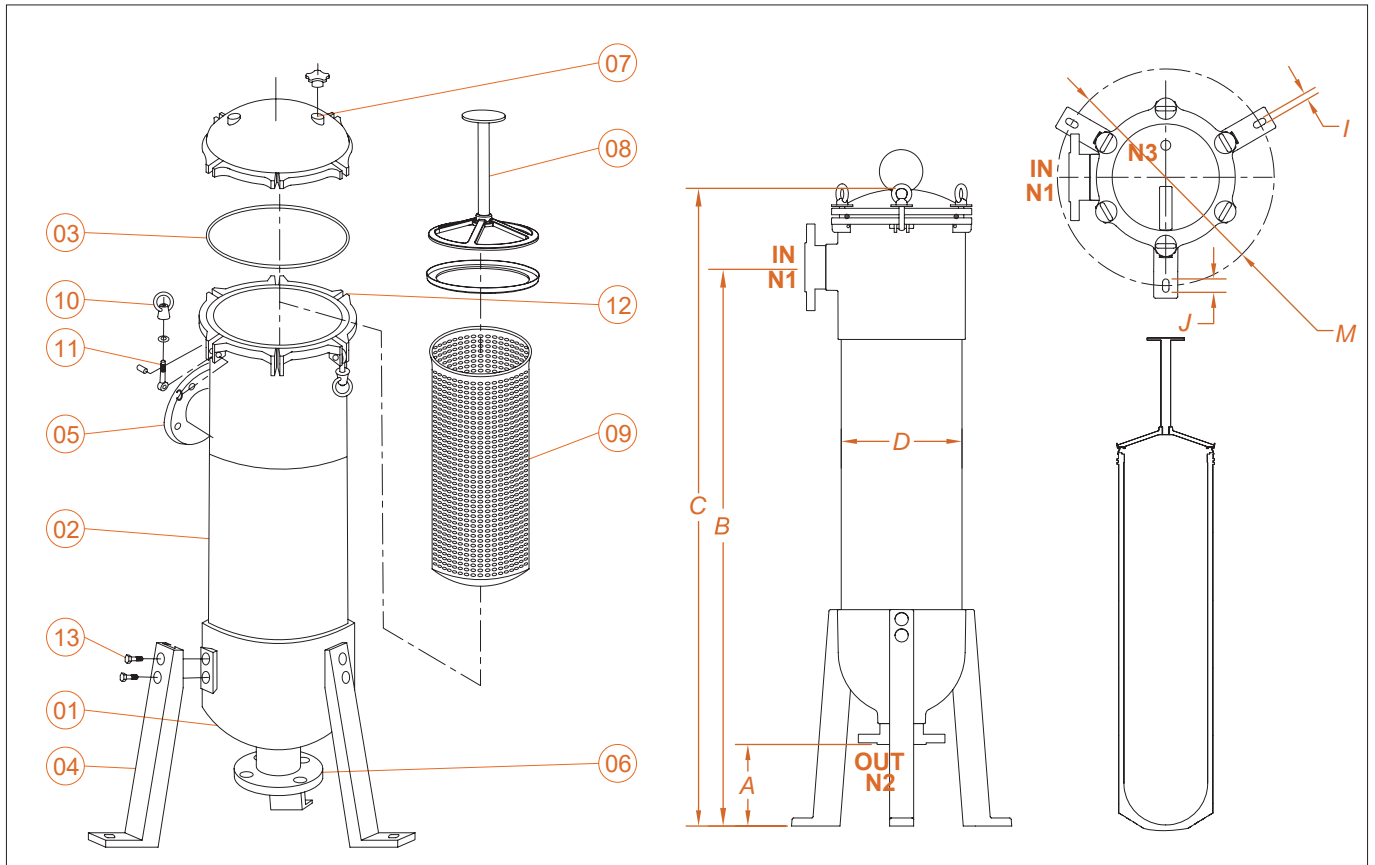

## Components

No.	Description	Q'ty
01	Pedestal	1
02	Body	1
03	O-ring	1
04	Leg Support	3
05	Inlet Port	1
06	Outlet Port	1
07	Vent	1
08	Support Basket	1
09	Basket	1
10	Eye Nut	6
11	Eye Bolt	6
12	Eye Bolt Socket	6
13	Screw	6

## Dimensions

Model	A	B	C	ØD	I	J	ØM	N1 N2	N3	Flow Rate	G. Weight
UFBG01U	150	665	820	225	12	22	407	DIN 2" / ANSI 2"	1/4"	0~ 90 GPM / 0 ~ 20 m <sup>3</sup> /hr	11.0kg
UFBG02U	150	1045	1200	225	12	22	407	DIN 2" / ANSI 2"	1/4"	0~200 GPM / 0 ~ 45 m <sup>3</sup> /hr	16.5kg

UNIT : mm

Customized housings are available on requests.

Actual flow rates will be determined on element selection and fluid viscosity.

For more information:

WEB: FLTR.com.au PHONE: (+61) 1300 62 4020 EMAIL: info@FLTR.com.au SKYPE: Purple.Engineering