

FRONT VIEW

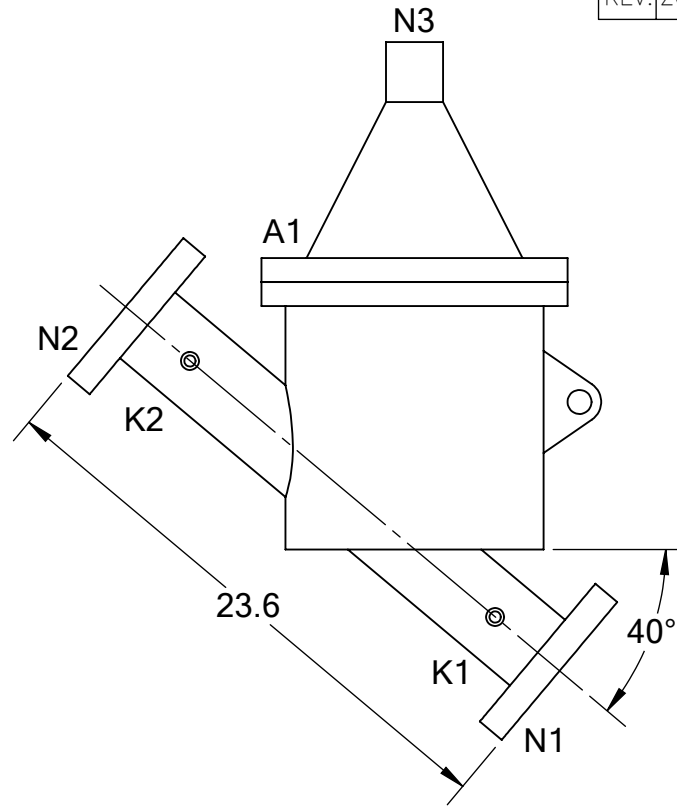

SIDE VIEW

REVISIONS				
REV.	ZONE	DESCRIPTION	DATE	INITIAL

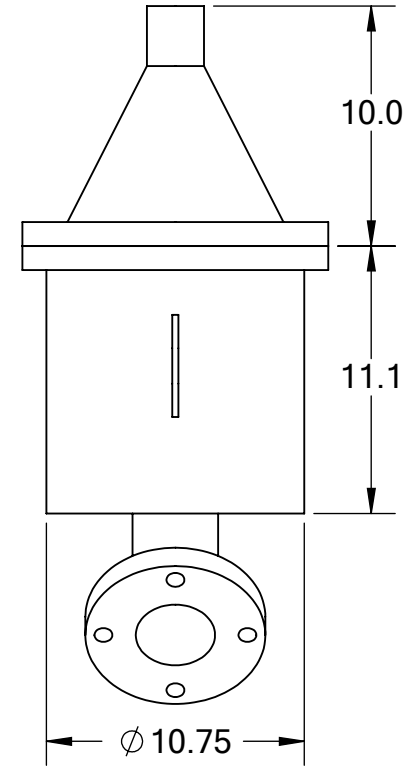

BACK VIEW

TECHNICAL DATA

FLOW RATE	MAX. 300 GPM (68 m ³ /hr)
SCREEN SIZE	____ MICRON
SCREEN AREA	2.0 SQ. FEET
WORKING TEMPERATURE	MAX. 200 °F
WORKING PRESSURE	MAX. 150 PSI
EMPTY WEIGHT	~100 LBS.
FULL WEIGHT	~150 LBS.

NOZZLE	CONNECTION	TYPE	SIZE	RATING
A1	SERVICE PORT	FLANGED	12.75"	
K1	HIGH PRESSURE CONN.	THREADED	1/4" NPT(2)	
K2	LOW PRESSURE CONN.	THREADED	1/4" NPT(2)	
N1	INLET	FLANGED	3" ASA	CLASS #150 F.F.S.O.
N2	OUTLET	FLANGED	3" ASA	CLASS #150 F.F.S.O.
N3	FLUSH OUTLET	THREADED	2" NPT	

TOLERANCES (UNLESS OTHERWISE SPECIFIED)	
FRAC. ±1/16	ANGLE ±1°
.X ±.1	
.XX ±.05	
.XXX ±.010	
MATERIAL: SST	
DRAWN BY: S. PERKINSON	
DATE: 10/12/11	
SCALE: 1:8	SHEET: 1 OF 1



TITLE: CSF3 FILTER, CUT DRAWING	
DRAWING NUMBER CSF-3-CUT-01	REV N/A